

GPLN has a very exciting project going on upstairs in the Gainesville Laboratory mezzanine.

***We are building a poultry industry model!***

The project coordinators are Len Chappell and Freddie Smith. We have support from our Commissioner, the Poultry Federation, and many model builders around the state.

The objectives are threefold:

- to show how the industry works from the farm to the table
- to describe the jobs and careers associated with the industry
- to outline the economic impact to the GA economy

Our target visitor is anyone who is interested in a tour in miniature of our entire industry and how it works. We will welcome schools and trade groups to learn more about our industry, its importance and its job opportunities!

We built a table for the model that is 7 x 32 feet. We plan to have moving trains bringing grain to the feed mill and chicken to the port of Savannah for exports, a moving “tour” vehicle, and lighted displays going around the farms and buildings. It will start with live production in the Piedmont, with chicken houses, a hatchery and a feed mill. Some of the chicken houses will be open to show the equipment inside. It will continue with processing and further processing plants, storage, freezers, and will end with poultry exports at the Port of Savannah. The model will also feature the support to the industry such as vaccine and equipment manufacturers, laboratories, government, universities, restaurants, supermarkets, and even a perfectly scaled replica of the Georgia Poultry Lab, shown below.

We are early in the process and open to ideas! If you are a model builder or a fan of model building, please do not hesitate to drop by and see where we are! Run your ideas by Freddie or Len! We might even put you to work!

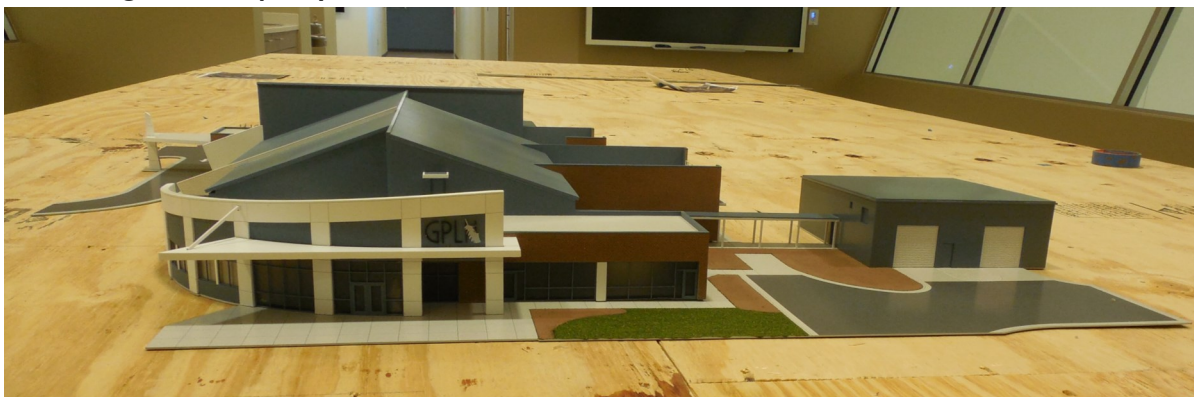

Tours and Visitors

- Mar 3: Cobb Vantress visitors
- Mar 4: Hall County Home Educators workshop and tour
- Mar 7: UGA CEAS students tour
- Mar 8: UGA Poultry Science tour
- Mar 30: UNG Poultry Science tour



Hall County Home Educators



UGA Poultry Science Students



UNG Poultry Science Students



UGA CEAS Students

GPLN Events



Stephanie Daniell

- Stephanie Daniell is working at the Gainesville Lab as part of a Brenau University externship program. Stephanie is working in many departments of the lab while fulfilling her internship in March and May. She has participated in field sample collections as part of her training.
- Mar 29: Dr. Doug Anderson, James Brantley and Elisa Castaneda organized and attended the Georgia Upland Game Bird Meeting in Tifton, GA.
- Mar 30: Dr. Doug Anderson, Elisa Castaneda and Dr. Louise Dufour-Zavala attended the Deep South Poultry Conference in Tifton, GA.
- Mar 31: Dr. Doug Anderson attended an AI Preparedness event at Zoo Atlanta.



Dr. Doug Anderson at the Zoo Atlanta AI Preparedness event